

Let's get started!

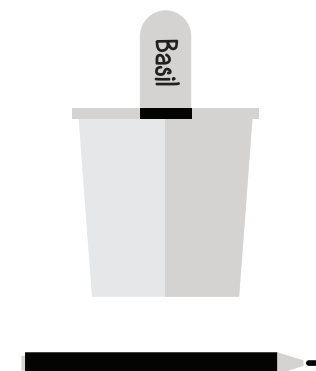

1. Insert the refills

Remove the refills from the package. Pop open the U-shaped lid on your garden and insert the soil capsules in the cavities in the garden. Put the U-shaped lids back on the cavity with the refill inside and press until you hear a click. Your refills are inserted.



2. Name your Plants

Keep track of your plants by labeling each plant capsule. The Smart Garden is machine washable so use a washable marker and you'll be able to change the text on the cavity lids based on each new plant your growing.

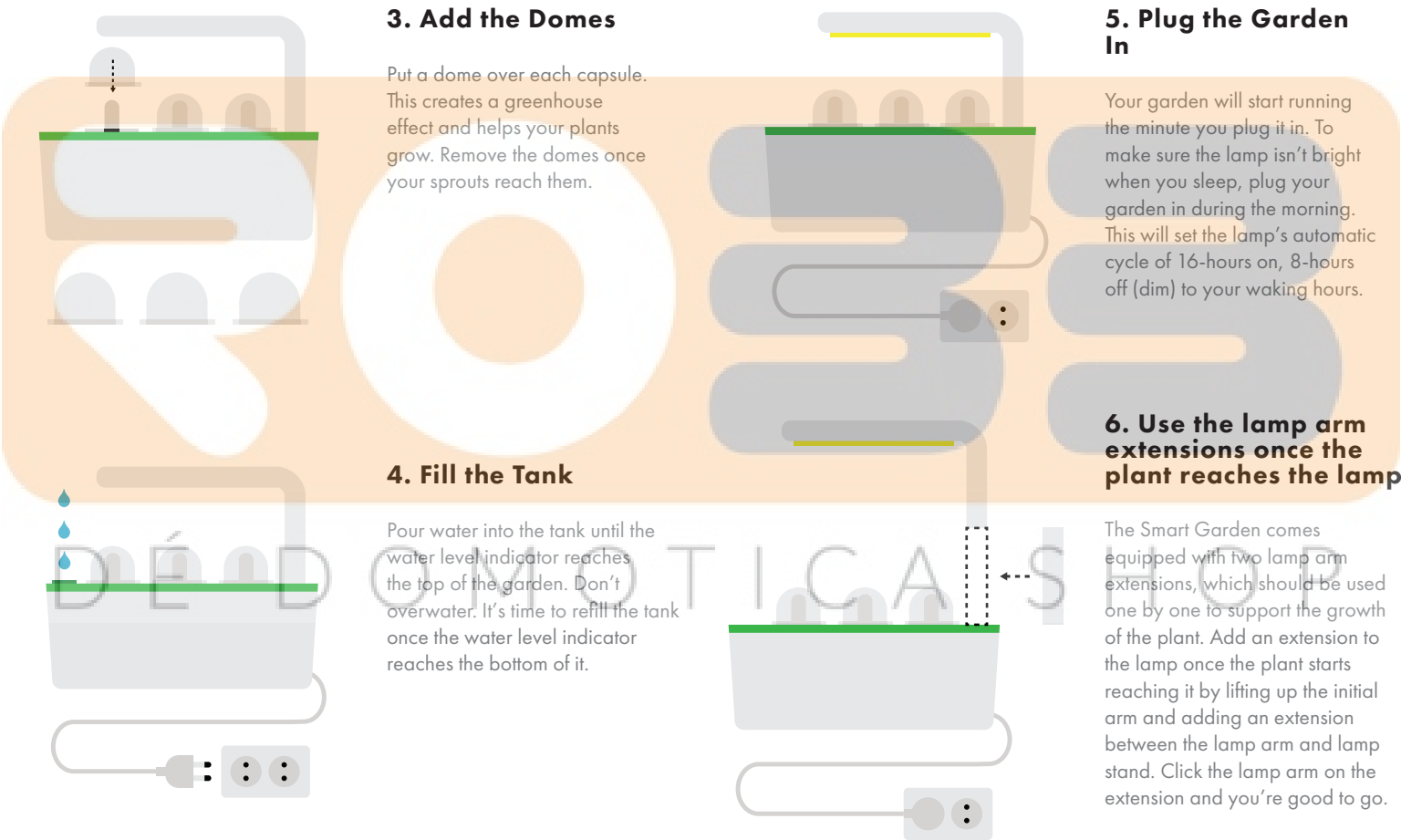

3. Add the Domes

Put a dome over each capsule. This creates a greenhouse effect and helps your plants grow. Remove the domes once your sprouts reach them.

4. Fill the Tank

Pour water into the tank until the water level indicator reaches the top of the garden. Don't overwater. It's time to refill the tank once the water level indicator reaches the bottom of it.

5. Plug the Garden In

Your garden will start running the minute you plug it in. To make sure the lamp isn't bright when you sleep, plug your garden in during the morning. This will set the lamp's automatic cycle of 16-hours on, 8-hours off (dim) to your waking hours.

6. Use the lamp arm extensions once the plant reaches the lamp

The Smart Garden comes equipped with two lamp arm extensions, which should be used one by one to support the growth of the plant. Add an extension to the lamp once the plant starts reaching it by lifting up the initial arm and adding an extension between the lamp arm and lamp stand. Click the lamp arm on the extension and you're good to go.

Activate!

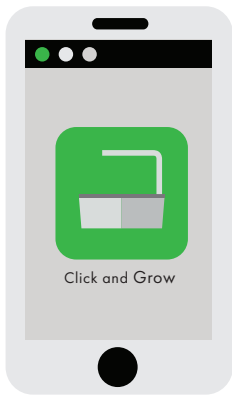

Maximize your garden's growth and activate your plants with the Click & Grow app!

Make your garden prizeworthy! Our app will give you expert tips, as well as access to exclusive deals and our full warranty. And did we mention it's free?



Get the app! Scan the QR code or visit clickandgrow.com/app and get in on this greatness!

CLICK & GROW™

Pro Tips for A Perfect Garden

Remove domes when the sprouts reach them.

The domes help your seedlings grow faster. But once your plants touch them, take off the domes. Big plants need a little room to bloom!

You can expect sprouts to appear in 1–3 weeks.

Different plants grow at different paces, so some of them will sprout within a week, while for others it may take up to 3 weeks. Be patient!

Adjust the lamp height accordingly.

The Smart Garden comes equipped with two lamp arm extensions, which should be used one by one to support the growth of the plant. Add an extension to the lamp once the plant starts reaching it by lifting up the initial arm and adding an extension between the lamp arm and lamp stand. If you're looking

to grow extremely tall plants, find additional lamp arm extensions available on Click & Grow website. Adjusting the lamp height based on plant will help the plants grow healthy and tall.

Personalize the lamp cycle.

The lamp has an automatic cycle: 16 hours on, 8 hours off (dim). The cycle starts the minute you plug your lamp in. To reset the lamp's schedule, unplug the garden and then plug it in at the time of day when you want the cycle to start. Easy as that!

Trim the plants if they start to reach the light.

The plants tend to grow in height, not width. Trimming them can make them yield more and live longer. Cut the plant with a sharp knife or scissors near a branch. The remaining part should have at least 2–4 pairs of leaves. Two new shoots will soon appear and the process can be repeated.

Let your creativity grow

When your plants are fully grown, be sure to enjoy them! Make tea, garnish your food, whip up fresh salad, or share your blooms with the world.

Your garden comes with a full warranty.

In the rare case your garden has any defects, let us know! We'll happily exchange it for a new one within the first 12 months from purchase.

Find out more:

Check www.clickandgrow.com for help and support.

With Click & Grow you can grow simply and eat naturally.

Welcome to your smart garden.

