



# Aqara Smart Roller Shade Controller Specifications

Lumi United Technology Co., Ltd.

all rights reserved

## 目录

1. Product introduction.....	2
1.1. Product overview.....	2
1.2. Product View.....	2
1.3. Selling points.....	2
2. Product parameters.....	3
3. Product instructions.....	3
3.1. LED status description.....	3
3.2. Operating Instructions.....	4
3.3. Instructions for installation.....	5
3.4. Usage Instructions.....	6
4. Product test information.....	7
4.1. Reliability test and quality test.....	7
4.2. Verification information.....	9



## Revision record

Revision	Revision Content	Revised by	Revised on
V1.0	1.Initial release	Glen	2020-11-23

# 1. Product introduction

## 1.1. Product overview

The Aqara Smart Roller Shade Controller is an electric smart curtain motor, which can automate ordinary roller blinds, Shangri-La blinds and other curtains. It has a built-in Zigbee wireless communication module. Paired with a hub device, it can realize functions such as remote control, timing opening and closing of curtains, and smart connection of several devices.

\*This product needs to be paired with an Aqara device with hub function.

## 1.2. Product View



## 1.3. Selling points

- (a) One Button Control
- (b) Automation support
- (c) Remote Control via App
- (d) Dual/Sheer Roller Shade Support
- (e) Open or Close on Preset Schedule
- (f) Customize Opening/Closing Position

## 2. Product parameters

Product name: Aqara Smart Roller Shade Controller

Product model: SRSC-M01

Rated voltage: 220/230V~ 50Hz

Rated power: 121W

Rated current: 0.53 A

Executive standard: Q/QLML016

Operating temperature: -10°C~+40°C

Operating humidity: 10%~95% RH, non-condensing

Pipe diameter: 35mm

Rated torque: 8N·m

Rated rotor speed: 17 r/min

Wireless connection: Zigbee

Working system: S2 4min

Zigbee Operation Frequency: 2405-2480 MHz

Zigbee Maximum Output Power: ≤13 dBm

## 3. Product instructions

### 3.1. LED status description

Indicator color	State description
-----------------	-------------------

Blue light flashes	Power on or click the button
Blue light is steady on	The device has connected to the network and the motor is running
The blue light continues to flash quickly	Connecting to the network
Red indicator light flashes slowly	The device has not connected to the network and the motor is running

### 3.2. Operating Instructions

Function	Operating Instructions
Set up/down travel	Adjust the curtain to the required up/down travel point with the up button, down button and stop button. After determining the position, press the stop key for 5 times in quick succession, and the motor rotates forward and backward once each, indicating that the up/down travel point is set successfully.
Delete travel	At the same time, press the up button + down button for 3 seconds. After the blue light is on, the indicator light will be loosened. The positive and negative rotation of the motor will be done once each, indicating the motor has been deleted successfully.

<p>Motor direction reversal</p>	<p>Long press the stop button 5s and release the blue light after it lights up.</p> <p>The positive and negative rotation of the motor is 1 time each, indicating the motor reversing successfully.</p>
---------------------------------	---

### 3.3. Instructions for installation

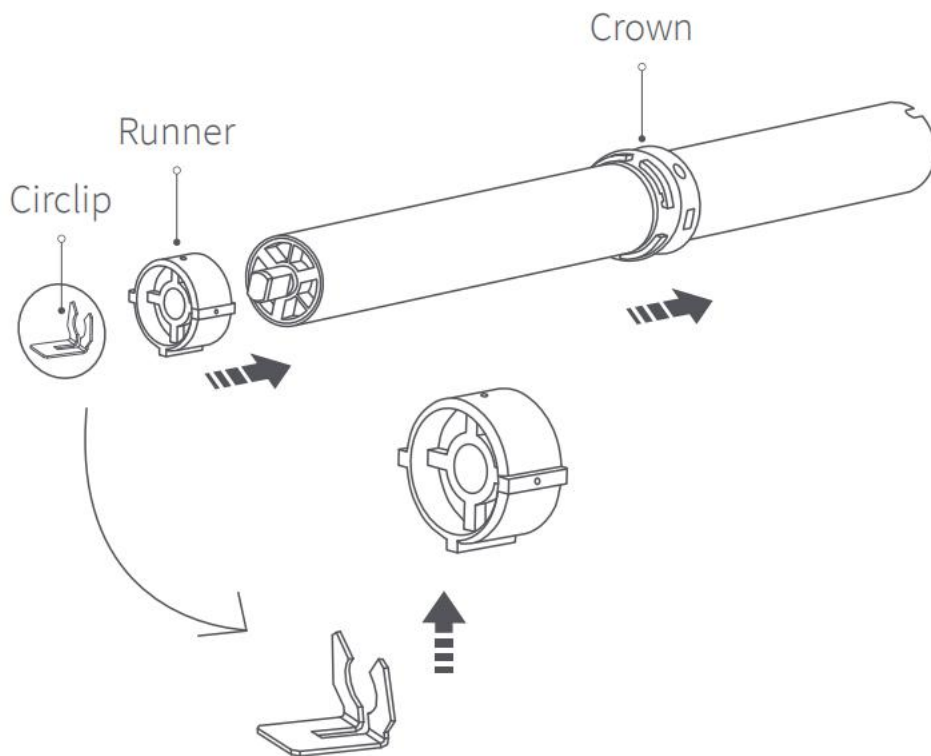

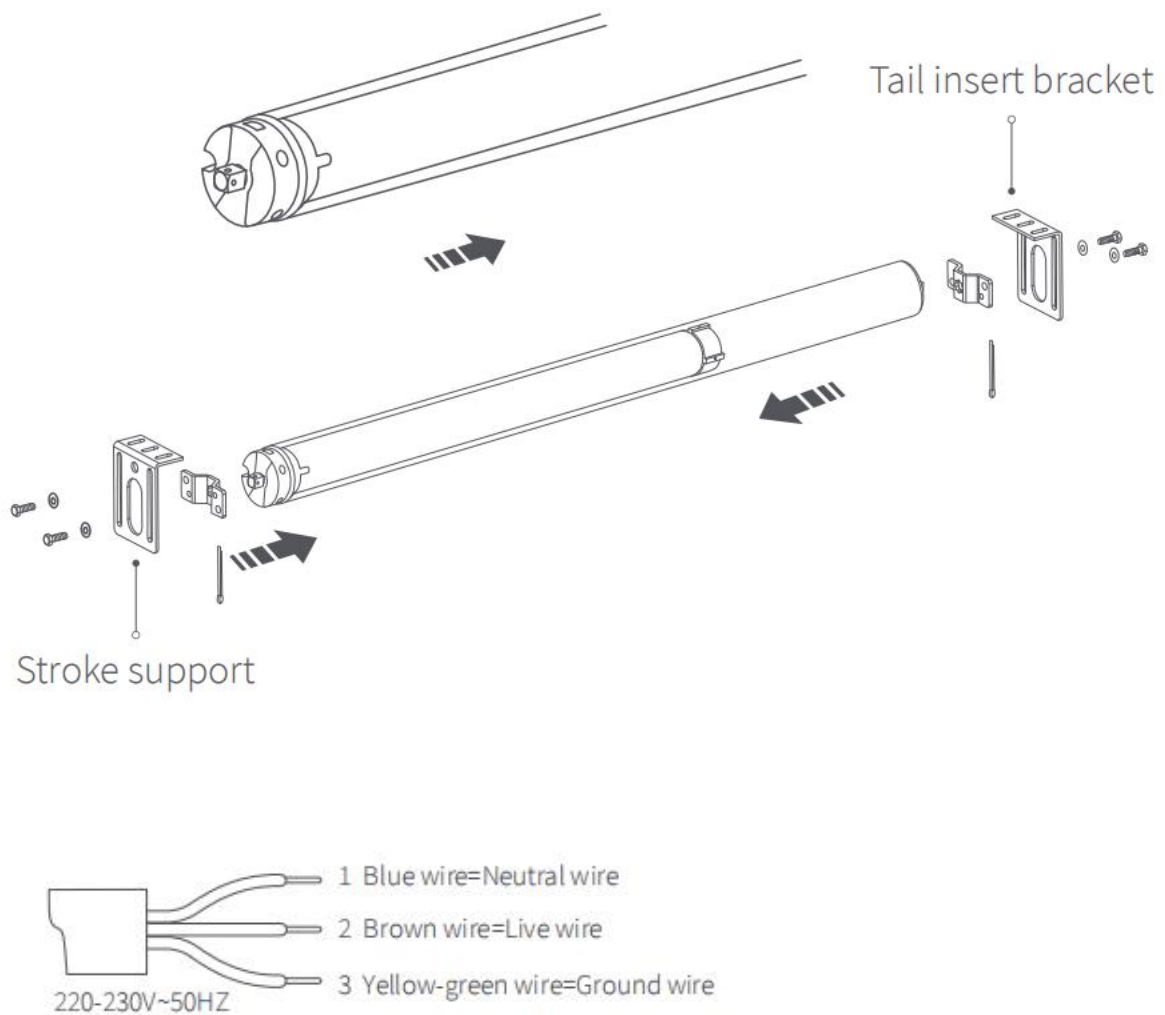

Put the motor into the wall of the shutter pipe and fix it firmly. Connect the control box to the RJ11 interface.

### 3.4. Usage Instructions

Connect to Aqara Home



1. Before activating the accessory, please make sure you have the Aqara Home app downloaded and the Aqara hub installed.

2. Open the app, click "+" in the upper right corner of the homepage, enter the "Add Device (Accessory)" page, select Aqara Smart Roller Shade Controller, and operate according to the prompts.

\* If the addition fails, please move the Hub closer to the device and try again.

Effective distance verification: At the preselected installation location, press the device reset button once, and the Hub will give a prompt tone, indicating that effective communication is possible between the device and the Hub.

## 4. Product test information

### 4.1. Reliability test and quality test

Name	Content	Description	Source
Aqara Smart Roller Shade Controller	Drop test	1000mm	LUMI
	High and low temperature test	-15°C: 48H 60°C: 48H	LUMI
	Thermal shock test	1cycle: -40°C: 30min; 80°C: 30min Total: 24 cycles	LUMI
	Salt spray test	The concentration of sodium chloride	LUMI

		solution: $5 \pm 0.1\%$ Temperature: 35°C Duration: 48H	
	Vibration test	Frequency range: 10 ~ 55Hz Test direction: 3 axes (X, Y, Z) Time / axis: 60 minutes / axis	LUMI
	Tension test of the power cord	Load weight: 16KG Duration: 30min	Provided by the supplier
	RJ-11 interface strength test	Thrust: 4KG Test directions: top, bottom, left, right	LUMI
	RJ-11 plug test	500 times	LUMI
	Aging test	Load: 12.8KG 10000 times	Provided by the supplier
	Shell material	RoHS report	Provided by the third party
	ESD test	$\pm 8\text{KV}$ air discharge $\pm 6\text{KV}$ contact discharge	LUMI

## 4.2. Verification information

No.	Country/Region	Identification Name
1	EU	CE RED
2		RoHS-EU
3		REACH+PAHs
4		POPs
5		WEEE
6		Packaging
7	Russia	EAC DOC