

[Skip to content](#)

Manuals+

User Manuals Simplified.



eufy Video Baby Monitor 720 User Manual

Home » [Eufy](#) » eupy Video Baby Monitor 720 User Manual 

Contents [[hide](#)]

- 1 eufy Video Baby Monitor 720 User Manual
- 2 WHAT'S IN THE BOX
- 3 FEATURE INTRODUCTION
 - 3.1 Monitor Features
- 4 Camera Features
- 5 SETTING UP THE CAMERA AND MONITOR
 - 5.1 Charge the Monitor
- 6 Charge the Camera
- 7 ADDING A NEW BABY CAMERA TO THE BABY MONITOR
- 8 USING THE BABY MONITOR
- 9 MOUNTING THE BABY CAMERA ON THE WALL
- 10 MONITOR MENU SETTINGS
- 11 Menu Settings
 - 11.1 Menu Options
 - 11.2 Description
- 12 On-screen Menu Icons
- 13 NOTICE
- 14 Declaration of Conformity
- 15 FCC Statement
- 16 FCC Radio Frequency Exposure Statement
- 17 Read More About This Manual & Download PDF:
- 18 File Downloads
- 19 References
- 20 Related Manuals

eufy Video Baby Monitor 720 User Manual

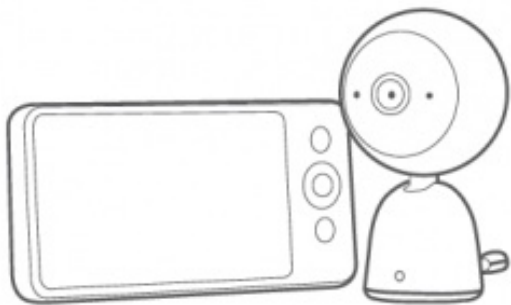

WHAT'S IN THE BOX



Video Baby Monitor nDP *Video Baby Monitor 720P*
Model: T8321-C *Model: T832 I -M*
FCC ID:2AOKB-T8321 C *FCC ID:2AOKS-T832 IM*
IC:23451-T8321C *IC:2345 I -T832 IM*



Wall Mount



Monitor Micro-USB
Power Cable (1 m)



Camera Micro
USB Power Cable

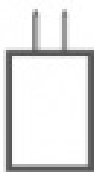

Camera Adapter
(SY 1A)

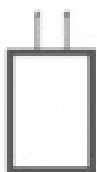

Monitor Adapter (SY 2A)

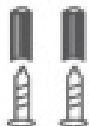

Mounting Screws



User Manual

Welcome Card

Welcome Card

Note: Power adapter varies by region.

FEATURE INTRODUCTION

Monitor Features

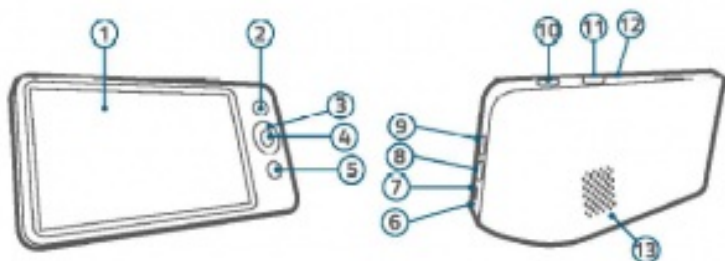

1. CD Screen
2. Menu button
3. Navigation button
4. OK button
Press to confirm the selection
Press to switch camera display if more than 2 cameras added
5. Return to previous level of menu | Talk button
Press and hold to speak to the camera
When menu is opened, press to return to the previous , level of menu
6. LED indicator
Red: charging
White: Fully charged
7. Micro USB charging port
8. Volume down
9. Volume up
10. Power button
11. Zoom button
12. Reset
13. Speaker

Camera Features

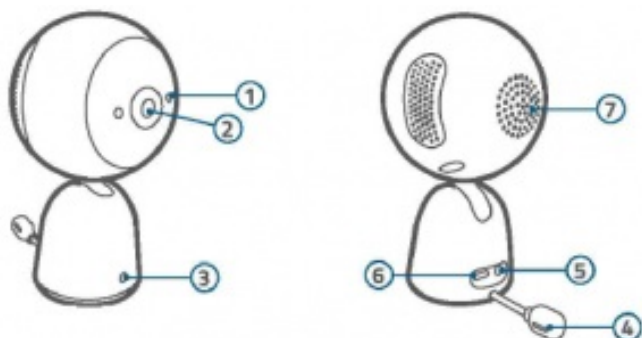

1. Microphone
2. Standard camera lens
3. **LED indicator**

4. Temperature sensor
5. Pairing button
6. Micro USB port
7. Speaker

SETTING UP THE CAMERA AND MONITOR

Charge the Monitor

Fully charge the monitor before use. To charge:

1. Connect one end of the micro USB cable to the baby monitor and the other end to the power adapter (5V/2A).
2. Plug the adapter into a power outlet.
3. Press and hold the power button for 2 seconds to turn the baby monitor on.



Charge the Camera

1. Connect one end of the micro USB cable to the baby camera, and the other end to the power adapter (5V/1A).
2. Plug the power adapter into a power outlet.

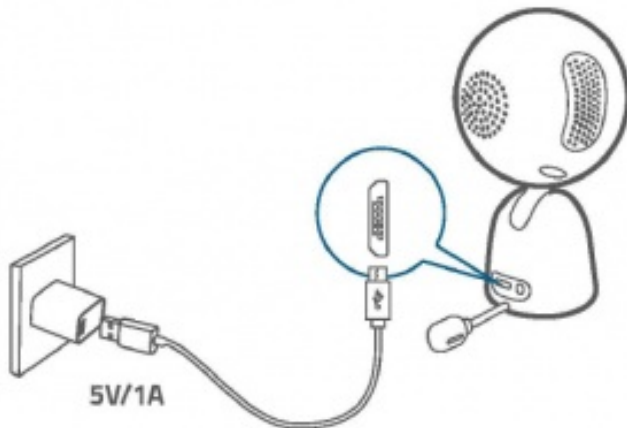

The new baby monitor and camera will set up automatically. You are all set to use the products after the monitor and camera are fully charged.

ADDING A NEW BABY CAMERA TO THE BABY MONITOR

The baby camera and baby monitor are paired and ready to use right out of the box. Refer to the following steps when adding extra baby cameras or after resetting a baby camera.

1. Enter menu setting, go to Camera -> Add Camera, then follow the onscreen instructions to start the pairing.

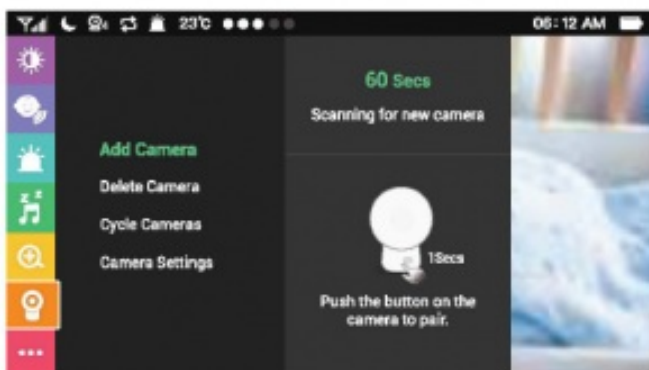

2. Press and hold the pairing button on the rear of the camera for 1 second until a notification prompt is heard.
3. Check the firmware version of the monitor (see image below) to make sure your baby monitor and camera are running the same, latest

firmware version.

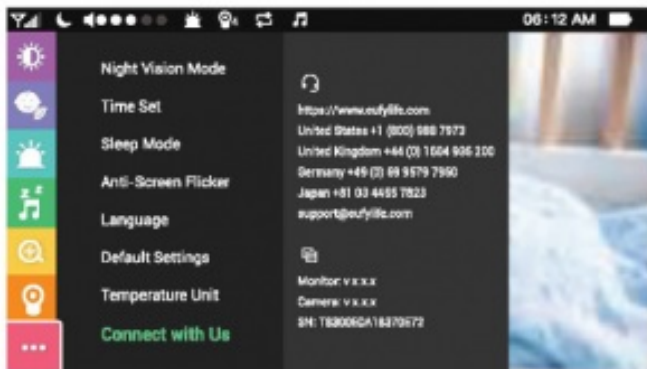

To check whether it is the latest version:

1. Visit the website below: <https://www.eufylife.com/support/5505/spaceview-baby-monitor>
2. If the firmware version is lower than the version shown online (highlighted in green), click the firmware version to download. The downloaded file includes firmware for both T8300 and T8321 models, make sure you use the TB32.1 firmware.
3. Follow the steps in the “eufy Security Software Upgrade Guide” video or Firmware Upgrade Manual to complete firmware upgrade.

Note:• The eufy Security Spaceview baby camera can be added to the monitor. Before adding: the camera1 make sure SpaceView baby camera is running the same, latest version : with the monitor1s. : Chrome OS is not supported for firmware upgrade. , Before you upgrade firmware, use the provided micro USB cable (1m) to connect the device needed to your computer.

USING THE BABY MONITOR

When more than 2 cameras are added to the monitor; you can manually switch among cameras by pressing the monitor’s OK button. Once the camera switch is completed, the icon of the selected camera will appear on the corner of the baby monitor. You can also select the “Cycle Camera” option. The screen cycles through the list of connected baby cameras according to the preset intervals.

Note: The monitor will emit a loud noise if placed too close to the camera. This is normal and is resolved once the camera is moved away from the monitor.

MOUNTING THE BABY CAMERA ON THE WALL

1. Place the wall mount against the wall, matching the direction as UP indicates. Mark the screw holes with a pencil.

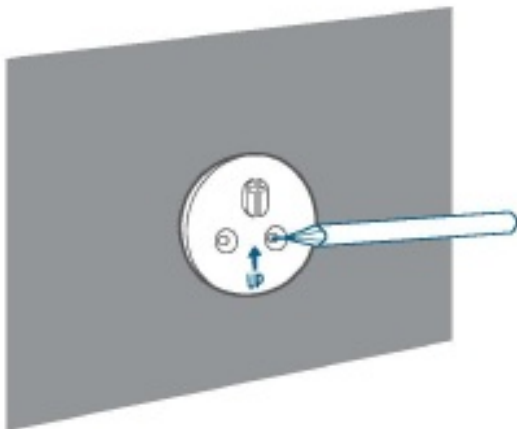

2. Drill 1/8" holes into the wall and then insert anchors into the holes. Anchors are not needed for wooden walls.

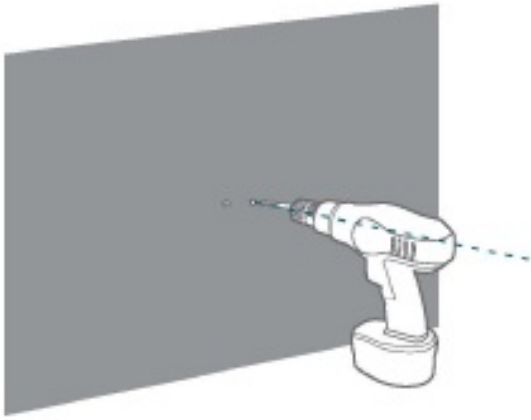

3. Insert the screws through the mounting holes of the wall mount and screw- into the anchors.

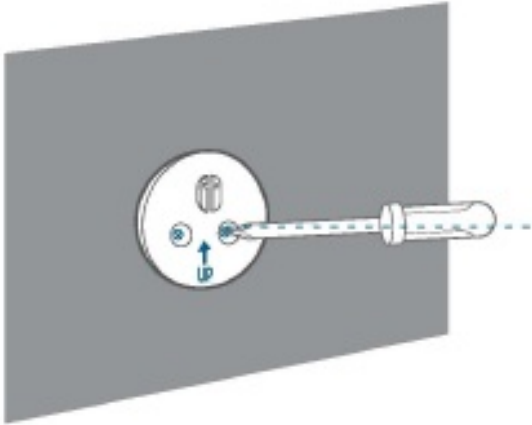

4. Snap the baby camera onto the wall mount. OB
5. To get the optimal viewing angle, rotate the camera (25°upwards, 60° backwards, 250° horizontally) manually, as pan and tilt functions are not supported on this model when using the navigation button.

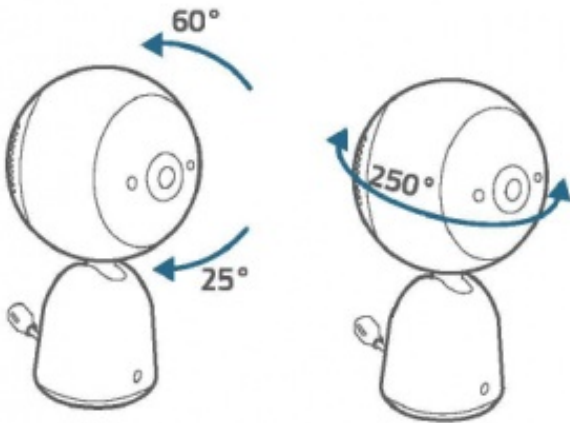

MONITOR MENU SETTINGS

Press and hold the power button to power on the monitor.. Press the menu button to open Menu Settings.

Menu Settings

Menu Options	Description
Brightness	Set the brightness of the screen.
Sleep Mode	Enable to automatically turn off the screen after 1 min, 3 min, 5 min or Off.
Sound Alert	<p>You can set the baby monitor to alert you when a specific noise level is Sound Alert detected.</p> <p>Note: Surrounding noise might set off false alarm.</p>
Lullaby	<p>Select your desired lullaby song. You can adjust the volume by selecting the volume button.</p> <p>Note: Sound Alert is automatically disabled when Lullaby function is enabled. Warning: Your baby's cry might be obscured by the sound of a lullaby.</p>
Zoom	Zoom in / out
Menu Options	Description
Alarm	<ul style="list-style-type: none"> • Set alarm on / off • Specify the duration when the alarm will sound • Set the volume • Set the temperature alert when it exceeds the specified temperature • Set an alarm clock
	<p>Add Camera</p> <p>Note: You can add up to 4 cameras per baby monitor.</p>
Camera	<p>Delete Camera</p> <p>Cycle Cameras</p> <p>Cycles through the list of connected baby cameras according to the preset interval.</p>
Time Set	Set the time on the monitor.
Night Vision Mode	<p>When Auto is enabled, the camera will change the screen color according to the light conditions in the room. When disabled, the camera will stick to daylight screen color and will not change when the surrounding environment is getting dark.</p> <p>Note: We recommend setting this function to On for most of the situations.</p>
Anti-Screen Flicker	Changes the refresh rate of the screen to prevent flickering.
Language	Sets the on-screen display menu language.
Default Settings	Resets all options to their default setting.
Temperature Unit	Select your desired temperature measure unit.
Connect with Us	Contact details

Note: The interval duration between each sound alert is 30 seconds. It will not sound alerts

during this interval, even if the conditions. are met to trigger an alert.

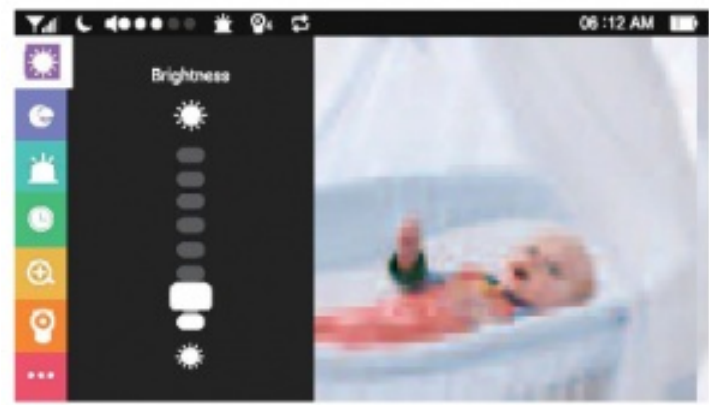

On-screen Menu Icons

Icon	Icon Description
	Wireless signal strength
	Night Vision Mode is enabled
	Shows the camera that is currently presenting on the baby monitor screen Note: This icon will not appear on the screen when there is only one camera connected to the monitor.
	Cycle Cameras enabled
	Sound Alert enabled
	Sound level of the room the camera is in
	Current time
	Current battery level of the baby monitor
	Current operating temperature

NOTICE

Warning
Strangulation Hazard: Children have STRANGLED in cords. Keep this cord out of the reach of children (more than 1m (3ft) away). Never use extension cords with AC Adapters. Only use the AC Adapters provided.

CE *This product complies with the radio interference requirements of the European Community.*

Declaration of Conformity

Hereby, Anker Innovations Limited declares that this device is in compliance with the essential requirements and other relevant provisions of Directive 2014/53/EU. For the declaration of conformity, visit the Web site: www.eufylife.com This product can be used across EU member states. Due to the used enclosure material, the product shall only be connected to a USB Interface of version 2.0 or higher. The connection to so called power USB is prohibited. The adapter shall be installed near the equipment and shall be easily accessible.

Do not use the Device in the environment at too high or too low temperature, never expose the Device under strong sunshine or too wet environment.

The suitable temperature for T8321-M and accessories is -20°C-40°C. The suitable temperature for T8321-C and accessories is -20°C-40°C. When charging, please place the device in an environment that has a normal room temperature and good ventilation. It is recommended to charge the device in an environment with a temperature that ranges from 5°C-25°C. Please ensure to use only the charger offered by the manufacturer. Using unauthorized charger may cause danger and violate the authorization of the device and the guarantee article. The charger output voltage / current is 5Vdc / 1A (for T8321-C) and 5Vdc / 2A (for T8321-M). The plug considered as disconnect device of adapter.

If you use a third-party charger; the recommended output voltage / current of the adapter is 5Vdc / 1A (for T8321-C) and 5Vdc / 2A (for T8321-M), and the adapter shall be CE approval type. CAUTION RISK OF EXPLOSION IF BATTERY IS REPLACED BY AN INCORRECT TYPE.

DISPOSE OF USED BATTERIES ACCORDING TO THE INSTRUCTIONS RF exposure information: The Maximum Permissible Exposure (MPE) level has been calculated based on a distance of d=20 cm between the device and the human body. To maintain compliance with RF exposure requirement, use product that maintain a 20cm distance between the device and human body. Operating Frequency Range: 2410-2477MHz. The T8321-C Max Output Power: 10.04dBm (EIRP), The T8321-M Max Output Power: 14.89dBm (EIRP). CE SAR: This T8321-M was tested for typical body-worn operations with the back of the handset kept 0 mm from the body. The SAR limit of Europe is 4.0 W/kg. Device types TB321-M has also been tested against this SAR limit. The highest SAR value reported under this standard during product certification for use at the limb is 1.707 W/kg. This device was tested for typical hand held

operations with the back of the device kept 0mm from the Limb. The T8300-C device has been evaluated to meet general RF exposure requirements and can be used in fixed exposure condition. RF exposure information: The Maximum Permissible Exposure (MPE) level has been calculated based on a distance of d=20 cm between the device and the human body. To maintain compliance with RF exposure requirement, use product that maintain a 20cm distance between the device and human body. The following importer is the responsible party (contact for EU matters only) Importer Anker Technology (UK) Ltd Importer Address: Suite E1, Fairgate House, 205 Kings Road, Tyseley, Birmingham, United Kingdom B11 2AA



This product is designed and manufactured with high quality materials and components, 100% which can be recycled and reused.



This symbol means the product must not be discarded as household waste, and should be delivered to an appropriate collection facility for recycling. Proper disposal and recycling helps protect natural resources, human health and the environment. For more information on disposal and recycling of this product, contact your local municipality, disposal service or the shop where you bought this product.

FCC Statement

This device complies with Part 15 of the FCC Rules. Operation is subject to the following two conditions: (1) this device may not cause harmful interference, and (2) this device must accept any interference received, including interference that may cause undesired operation. Warning: Changes or modifications not expressly approved by the party responsible for compliance could void the user's authority to operate the equipment. Note: This equipment has been tested and found to comply with the limits for a Class B digital device, pursuant to Part 15 of the FCC Rules. These limits are designed to provide reasonable protection against harmful interference in a residential installation. This equipment generates uses and can radiate radio frequency energy and, if not installed and used in accordance with the instructions, may cause harmful interference to radio communications. However, there is no guarantee that interference will not occur in a particular installation. If this equipment does cause harmful interference to radio or television reception, which can be determined by turning the equipment off and on, the user is encouraged to try to correct the interference by one or more of the following measures: (1) Reorient or relocate the receiving antenna. (2) Increase the separation between the equipment and receiver. (3) Connect the equipment into an outlet on a circuit different from that to which the receiver is connected. (4) Consult the dealer or an experienced radio / TV technician for help.

FCC Radio Frequency Exposure Statement

The T8321-C device has been evaluated to meet general RF exposure requirements. The T8321-C can be used in fixed exposure condition. The minimum separation distance is 20cm. This T8321-M was tested for typical body-worn operations with the back of the handset kept 0 mm from the body.

RF Exposure Information (SAR)

The Extremity SAR limit of FCC for Hand held is 1.0 W/kg. Device is recommended to use in hand held only and SAR when hand held is 1.804 W/kg

Worn on body will have unexpected RF exposure RISK.

FCC ID (for T8321-C): 2AOK8-T8321C

FCC ID (for T8321-M): 2AOKB-TB321M

The following importer is the responsible party.

Company Name: POWER MOBILE LIFE, LLC

Address: 400 108th Ave NE Ste 400, Bellevue, WA 98004-5541

Telephone: 1-800-988-7973

CUSTOMER SERVICE

Anker Innovations Limited

Room 1318-19, Hollywood Plaza, 610 Nathan Road, Mongkok, Kowloon, Hong Kong

■ Warranty

12-month limited warranty

Read More About This Manual & Download PDF:



File Downloads



User Manual [Download](#) [optimized]

Video Baby Monitor 720 [Download](#)

References

-  [FCC ID:2AOKB-T8321](#)
-  [FCC ID:2AOKS-T832](#)

Related Manuals

1. [Anker Eufy Security Video Doorbell T8200 User Manual](#) Quick Start Guide Video Doorbell 2K (Wired) FCC ID:2AOKB-T8200 IC:23451-T8200...
2. [eufy RoboVac User Manual](#) eufy RoboVac Important Safety Instructions To reduce the risk of...
3. [Anker Eufy Motion Sensor User Manual](#) USER MANUAL Motion Sensor Anker Innovations Limited. All rights reserved....
4. [Eufy Security Keypad T8960 User Manual](#) USER MANUAL Eufy Security Keypad T8960 Anker Innovations Limited. All...
5. [eufy T2108 RoboVac 11S User Manual](#) eufy T2108 RoboVac 11S User Manual Owner's Manual RoboVac 11S...
6. [Eufy HomeBase + Camera + Entry Sensor User Manual](#) USER MANUAL Eufy HomeBase + Camera + Entry Sensor Anker...