

### 3. Mute alarms

After you press the button when a sound alarm is triggered, the alarm will mute for 5 minutes and continue altering if the alarm persists 5 minutes later.

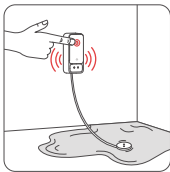

Press the button to cancel the alarm.

### 4. Clear alarms

Take the device out of water and dry it. Then the alarm will be cleared and our app will send a notification.

### 5. App settings

On the device page of the SwitchBot app, you can view device status and messages regarding your water detector. You can also enable leak/dry alert or set alarm duration, alarm sound interval and alarm volume.

### 6. Voice reminders

For details about how to customize voice reminders, scan this QR code please.



## LED Indicator Light

LED Indicator Light	Description
○ Flashes white once	Powering on
○ Fast flashes white for 120 seconds	In pairing mode
○ Fast flashes white for 15 seconds	Device restarting
● Fast flashes red	Alarm triggered
● Flashes red 2 times	Device testing

## Battery Replacement

When your device's battery is low, our app will send a low battery notification. Replace batteries as described below:

1. Use the provided tool to open the battery cover on the back. (After replacement, ensure the cover is tightly closed for a better waterproof effect.)
2. Replace the batteries with new ones and test your detector.

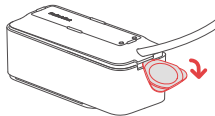

## Resetting Factory Settings

Press and hold the button for 15 seconds, then release it. The Indicator Light will stay on for 2 seconds and the Buzzer will sound for 2 seconds, which means your device has been restored to its default factory settings.

## Firmware Upgrades

In order to improve user experience, we will regularly release firmware updates to introduce new functions and solve any software defects that may occur during usage. When a new firmware version is available, we will send an upgrade notification to your account via our app. When upgrading, please make sure your product has sufficient battery and make sure your smartphone is within range to prevent interference.

## Frequently Asked Questions

**Q: My water detector doesn't work properly, why?**

A:

- 1) Check whether the batteries are installed correctly.
- 2) Check device battery level.

**Q: My device failed to connect to Wi-Fi, or the connection is unstable, what can I do?**

A:

- 1) Make sure you are using a 2.4 GHz Wi-Fi network.
- 2) Check whether your Wi-Fi name and password are entered correctly.
- 3) Make sure your device is within range of router signals.

**Q: My SwitchBot app does not send notifications, or there is a delay in app notifications, is this normal?**

**A:**

- 1) Make sure you have enabled device notifications via our app.
- 2) Check your home network's quality and whether the device is within Wi-Fi range.

Please visit our website or scan the QR code below for more information.



## Specifications

**Color:** White

**Material:** ABS

**Size:** 78 × 32 × 32 mm (3.1 × 1.3 × 1.3 in.)

**Weight:** 70 g (2.4 oz.)

**Water Resistance:** IP67

**Noise:** 100 dB

**Power:** 2 × AAA battery

**Battery Life:** Approx. 2 years

**Cable Length:** 1 m (39.3 in.)

**Operating Temperature:**

0 °C to 40 °C (32 °F to 140 °F)

**Operating Humidity:** 0% to 99% RH

**Connectivity:** Wi-Fi 2.4 GHz + BLE 4.2 or above

**System Requirements:**

iOS 14.0 +, Android OS 5.0 +

## Warranty

We warrant to the original owner of the product that the product will be free from defects in materials and workmanship. Please note that this limited warranty does not cover:

1. Products submitted beyond the original limited warranty period.
2. Products on which repairs or modifying have been attempted.
3. Products subjected to falls, extreme temperatures, water, or other operating conditions outside the product specifications.
4. Damage due to natural disaster (including but not limited to lightning, flood, tornado, earthquake, or hurricane, etc.).

5. Damage due to misuse, abuse, negligence or casualty (e.g. fire).
6. Other damage that is not attributable to defects in the manufacture of product materials.
7. Products purchased from unauthorized resellers.
8. Consumable parts (including but not limited to batteries).
9. Natural wear of the product.

## Contact & Support

Feedback: If you have any concerns or problems when using our products, please send feedback via our app through the Profile > Help & Feedback page.

Setup and Troubleshooting:

[support.switch-bot.com](mailto:support.switch-bot.com)

Support Email: [support@switch-bot.com](mailto:support@switch-bot.com)

## CE Warning

To comply with RF exposure requirements, a minimum separation distance of 20 cm must be maintained between the user's body and the device, including the antenna. Use only the supplied or an approved antenna. This device is in compliance with the essential requirements and other relevant provisions of directive 2014/53/EU. All essential radio test suites have been carried out.

### CE DOC

Hereby, Woan Technology (Shenzhen) Co., Ltd. declares that the radio equipment typ ( W4402000 ) is in compliance with Directive 2014/53/EU. The full text of the EU declaration of conformity is available at the following internet address: [support.switch-bot.com](mailto:support.switch-bot.com)

This product can be used in EU member states and UK.

Manufacturer: Woan Technology (Shenzhen) Co., Ltd.

Address: Room 1101, Qiancheng Commercial Center, No. 5 Haicheng Road, Mabu Community, Xixiang Subdistrict, Bao'an District, Shenzhen, Guangdong, P.R.China, 518100

CE representative: XDH Tech

Address: 2 Rue Coysevox Bureau 3, Lyon, France

Operation frequency

Wi-Fi: 2412 MHz to 2472 MHz

BLE: 2402 MHz to 2480 MHz

Operation temperature: 0 to 40 °C

## FCC Warning

This device complies with Part 15 of the FCC Rules. Operation is subject to the following two conditions:  
(1) This device may not cause harmful interference.  
(2) This device must accept any interference received, including interference that may cause undesired operation.

NOTE: This equipment has been tested and found to comply with the limits for a Class B digital device, pursuant to part 15 of the FCC Rules. These limits are designed to provide reasonable protection against harmful interference in a residential installation.

This equipment generates uses and can radiate radio frequency energy and, if not installed and used in accordance with the instructions, may cause harmful interference to radio communications. However, there is no guarantee that interference will not occur in a particular installation. If this equipment does cause harmful interference to radio or

television reception, which can be determined by turning the equipment off and on, the user is encouraged to try to correct the interference by one or more of the following measures:

- Reorient or relocate the receiving antenna.
- Increase the separation between the equipment and receiver.
- Connect the equipment into an outlet on a circuit different from that to which the receiver is connected.
- Consult the dealer or an experienced radio/TV technician for help.

NOTE: The manufacturer is not responsible for any radio or TV interference caused by unauthorized modifications to this equipment. Such modifications could void the user's authority to operate the equipment.

### **FCC Radiation Exposure Statement**

The device has been evaluated to meet general RF exposure requirement. The device can be used in portable exposure condition without restriction.

## **IC Warning**

This device contains license-exempt transmitter(s)/ receiver(s) that comply with Innovation, Science and Economic Development Canada's license-exempt RSS(s). Operation is subject to the following two conditions:

- (1) This device may not cause interference.
- (2) This device must accept any interference, including interference that may cause undesired operation of the device.

### **IC Radiation Exposure Statement**

This equipment complies with the IC radiation exposure limits established for uncontrolled environment. This equipment must be installed and operated at least 20 cm from a radiator or your body. Cet équipement est conforme aux limites d'exposition aux rayonnements de la IC établies pour un environnement non contrôlé. Cet équipement doit être ins.