

Dismounting In Wall Box.

①
Remove the two screws securing the cover plate.

②
Remove the wall switch cover plate.

③
Remove the two screws securing the wall switch to the wall box. Disconnect both wires from the wall switch.

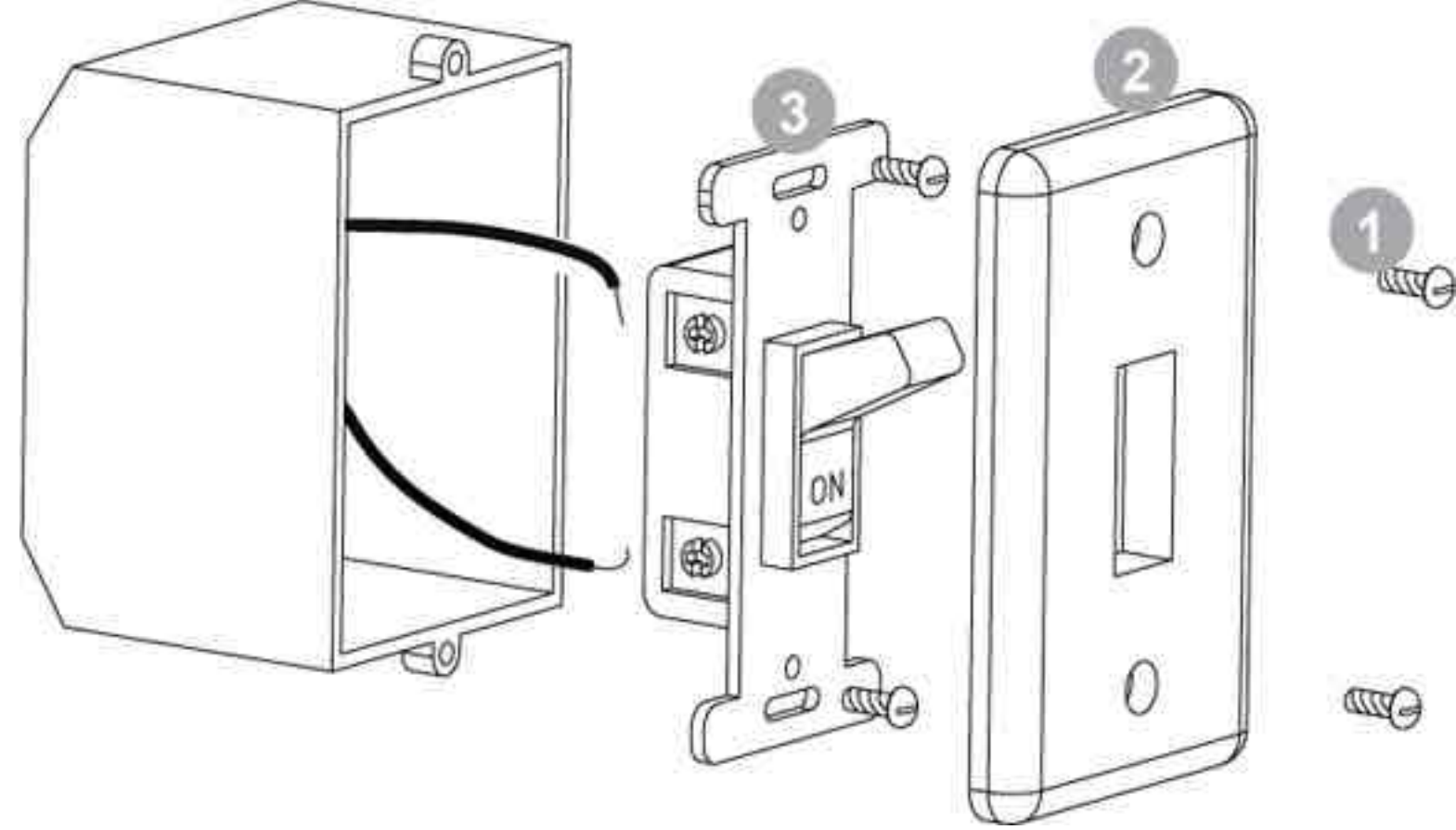

Preparing and Connecting Wires

The Aeotec Micro Smart Energy Illuminator G2 must first be powered by a 3-wire system in order to operate. The wiring diagram is as follows:

Note
The “3V Out” terminal should be used only with the Aeon Micro Touch.



Cut wire if necessary



Strip Gage (measure bare here)

Diagram

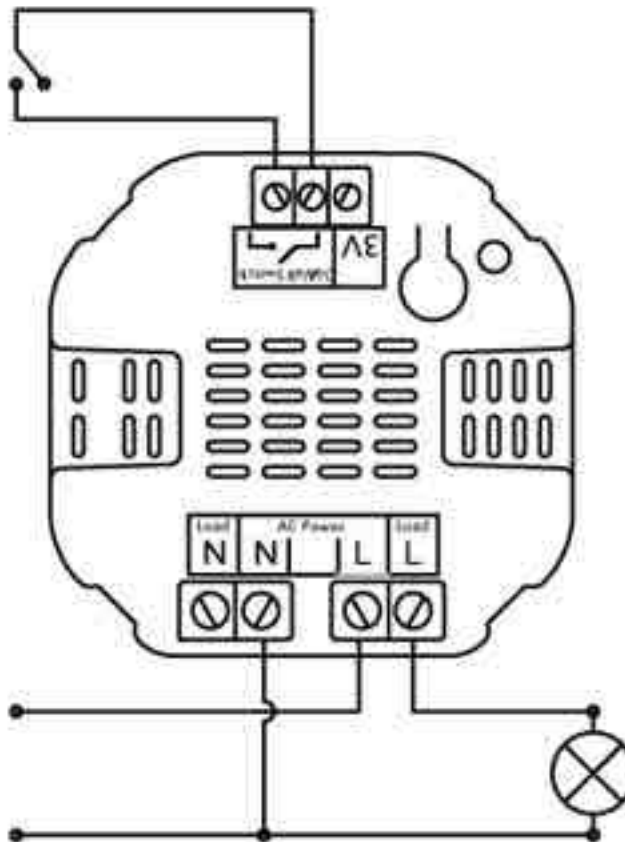
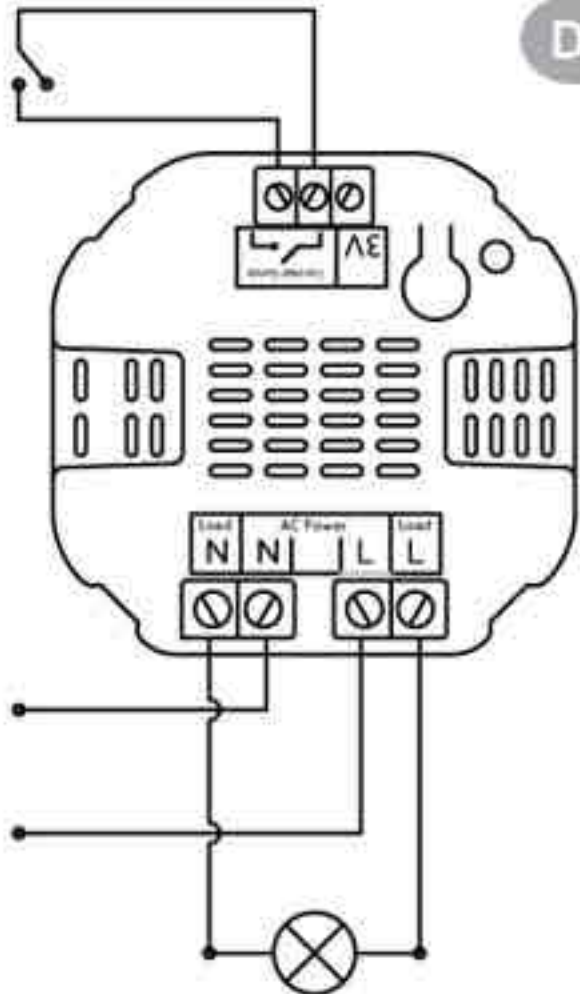

1

Live – Hot wire (Black wire) Connect to Live terminal of Micro Smart Energy Illuminator G2.

2

Neutral (White wire) Note! If this wire is not present in the box, a neutral wire must be pulled into the box.

3

Load wire – Connect to Load terminal of Micro Smart Energy Illuminator G2.

4

Signal connection – Using two 18 AWG copper wires, connect the terminals of the wall switch to Micro Smart Energy Illuminator G2 as shown.

- Make sure that the ends of the wires from the wall box are straight (cut if necessary).
- Remove insulation from each wire and the wall box as shown.

5

Side wire connection

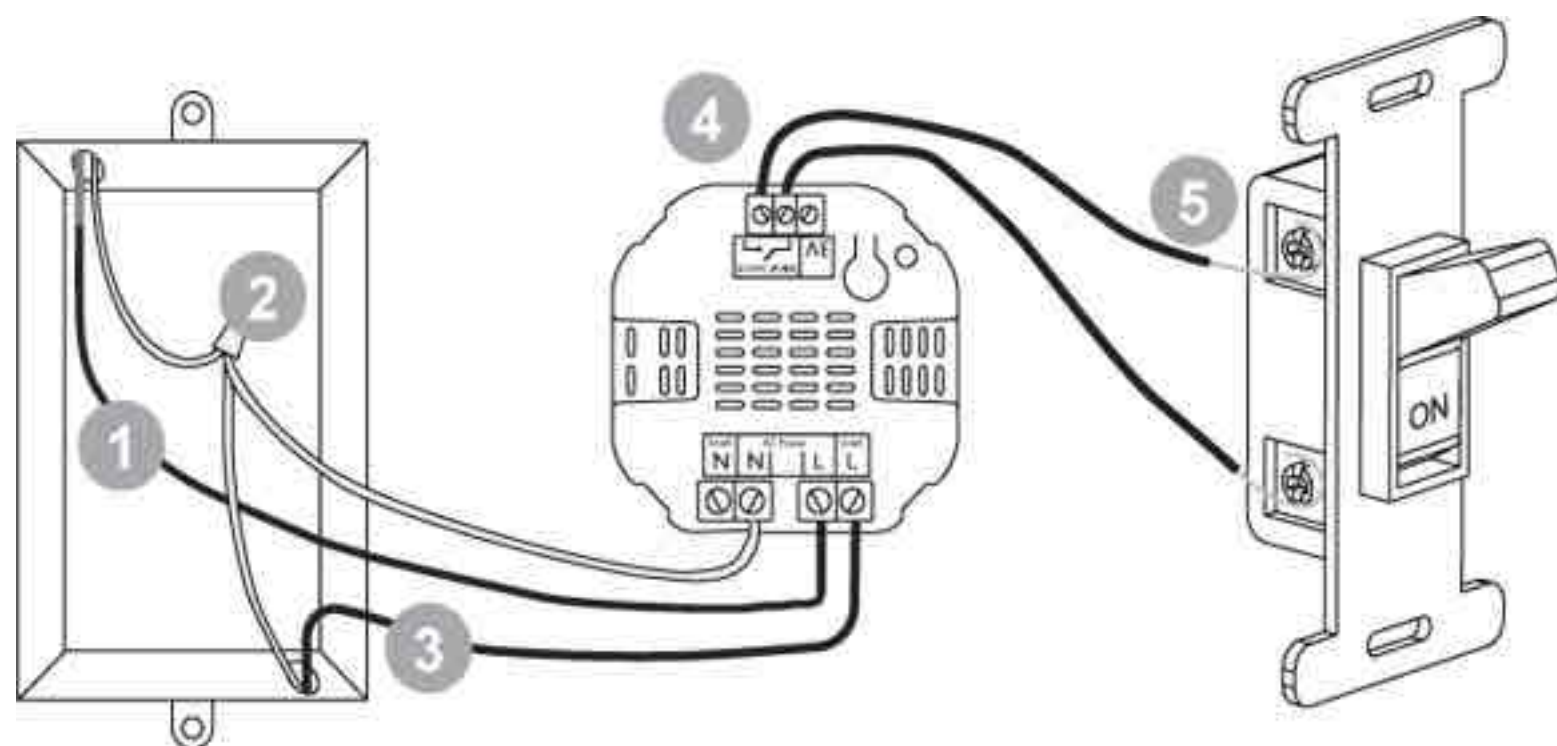

Mounting In Wall Box.

1

Position all wires to provide room for the device. Place Micro Smart Energy Illuminator G2 inside the wall box towards the back of the box.

2

Position the antenna towards the back of the box, away from all other wiring.

3

Reinstall the wall switch to the wall box.

4

Reinstall the cover plate onto the wall box.

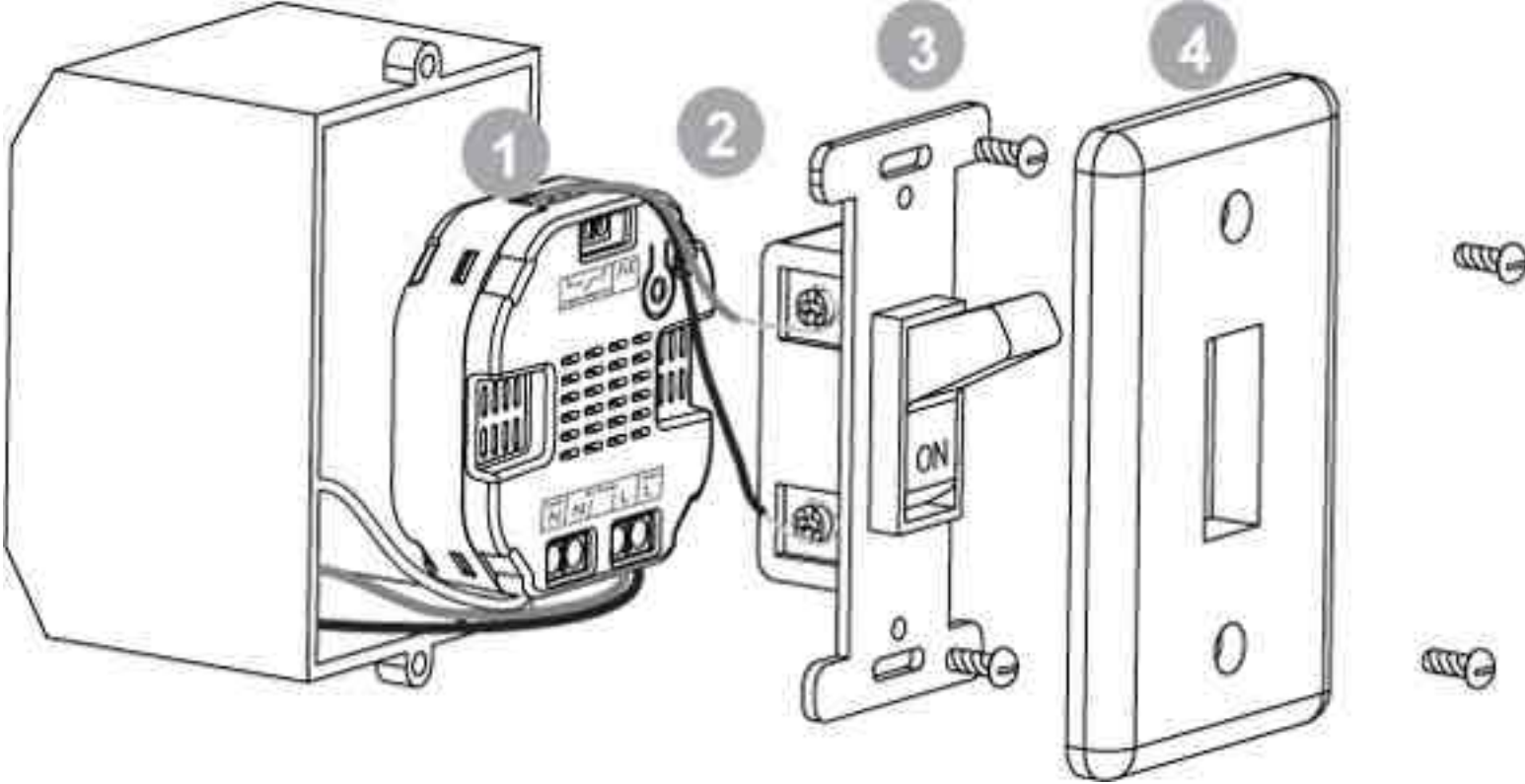

Restore Power

Restore power at the circuit breaker or fuse. **Installation is complete.**

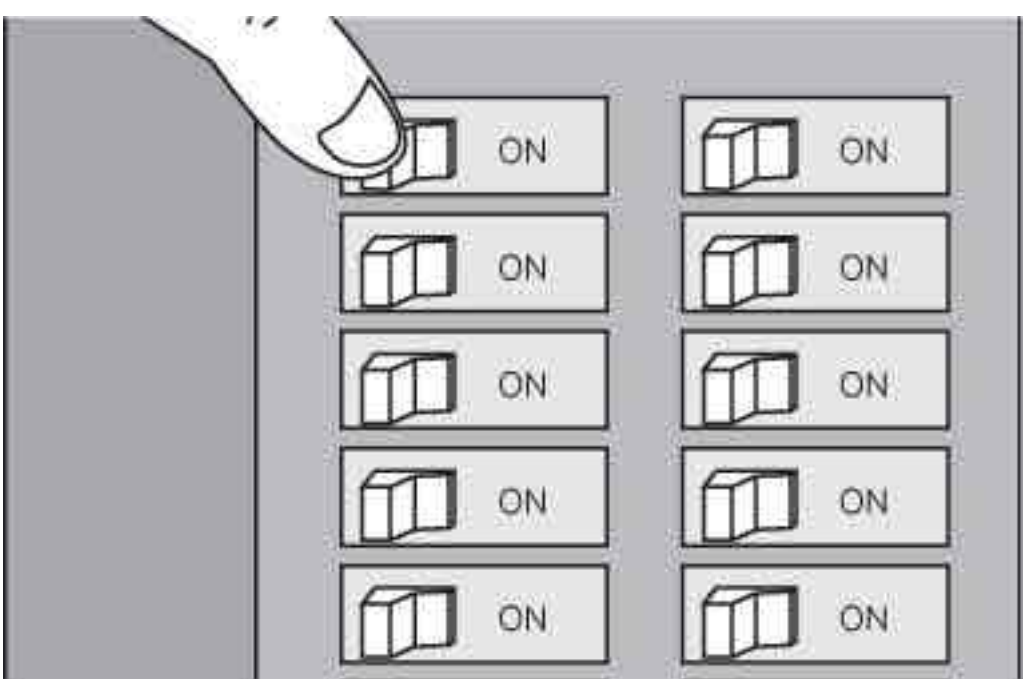

Z-Wave Network Instructions:

The Aeotec Micro Smart Energy Illuminator G2 must be paired (included) into a Z-Wave network before it can receive Z-Wave commands to turn on/off/dim and report its energy usage. The Micro Smart Energy Illuminator G2 can only communicate to devices within it's own Z-Wave network.

Note

The LED on the Micro Smart Energy Illuminator G2 will blink if it is currently not paired into a Z-Wave network.

Adding/Including/Pairing the Micro Smart Energy Illuminator G2

into a Z-Wave Network

1

Press the button labeled "Include" on the Aeotec Minimote to begin the Z-Wave inclusion process.

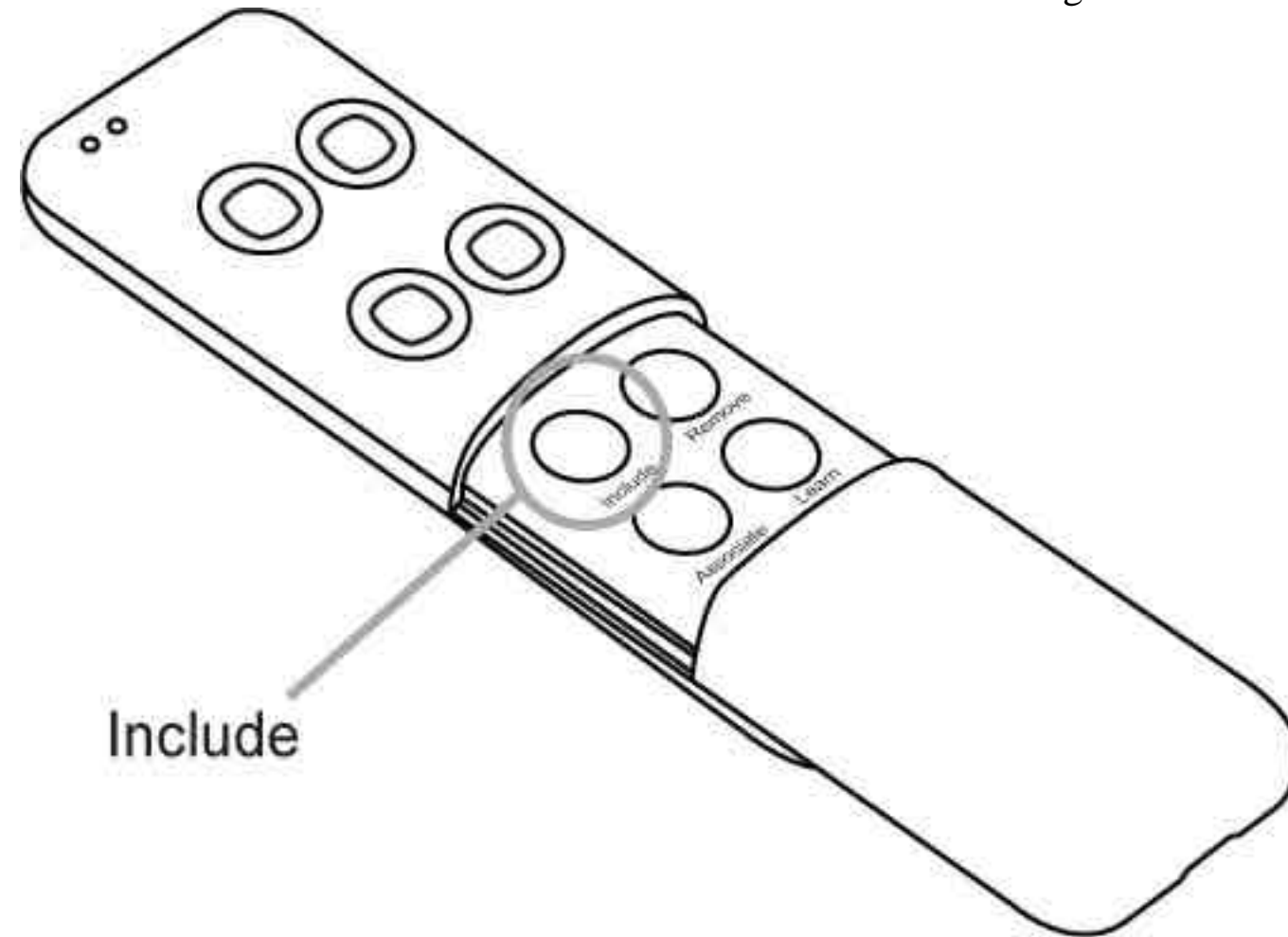

Note

To include the Aeotec Micro Smart Energy Illuminator G2 with other controllers, please consult the operation manual for these controllers on how to include Z-Wave products into an existing network.

2

While the Micro Smart Energy Illuminator G2 is powered in a 3-wire system, the external switch/button can be toggled to initiate pairing into the Z-Wave network. Or the internal button can be pushed to initiate pairing into the Z-Wave network, if Micro Smart Energy Illuminator G2 was not put into in-wall box.

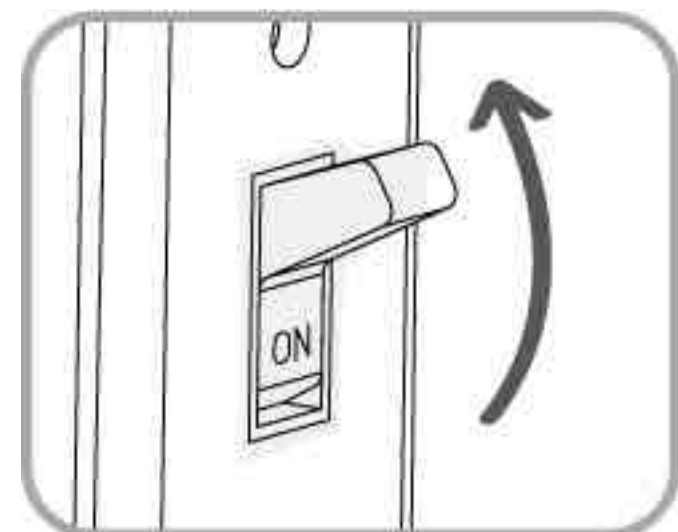

Troubleshooting

If the Aeotec Micro Smart Energy Illuminator G2 was not successfully included into any Z-Wave network, the LED will be blinking slowly continually. If the Aeotec Micro Smart Energy Illuminator G2

was successfully included to a Z-Wave network, the Status Indication LED will either be solid on or off (depending on if the switch is on or off).

Removing/Resetting the Micro Smart Energy Illuminator G2 from your Z-Wave Network

1

Press the button labeled "Remove" on the Aeotec Minimote to begin the Z-Wave removal process.

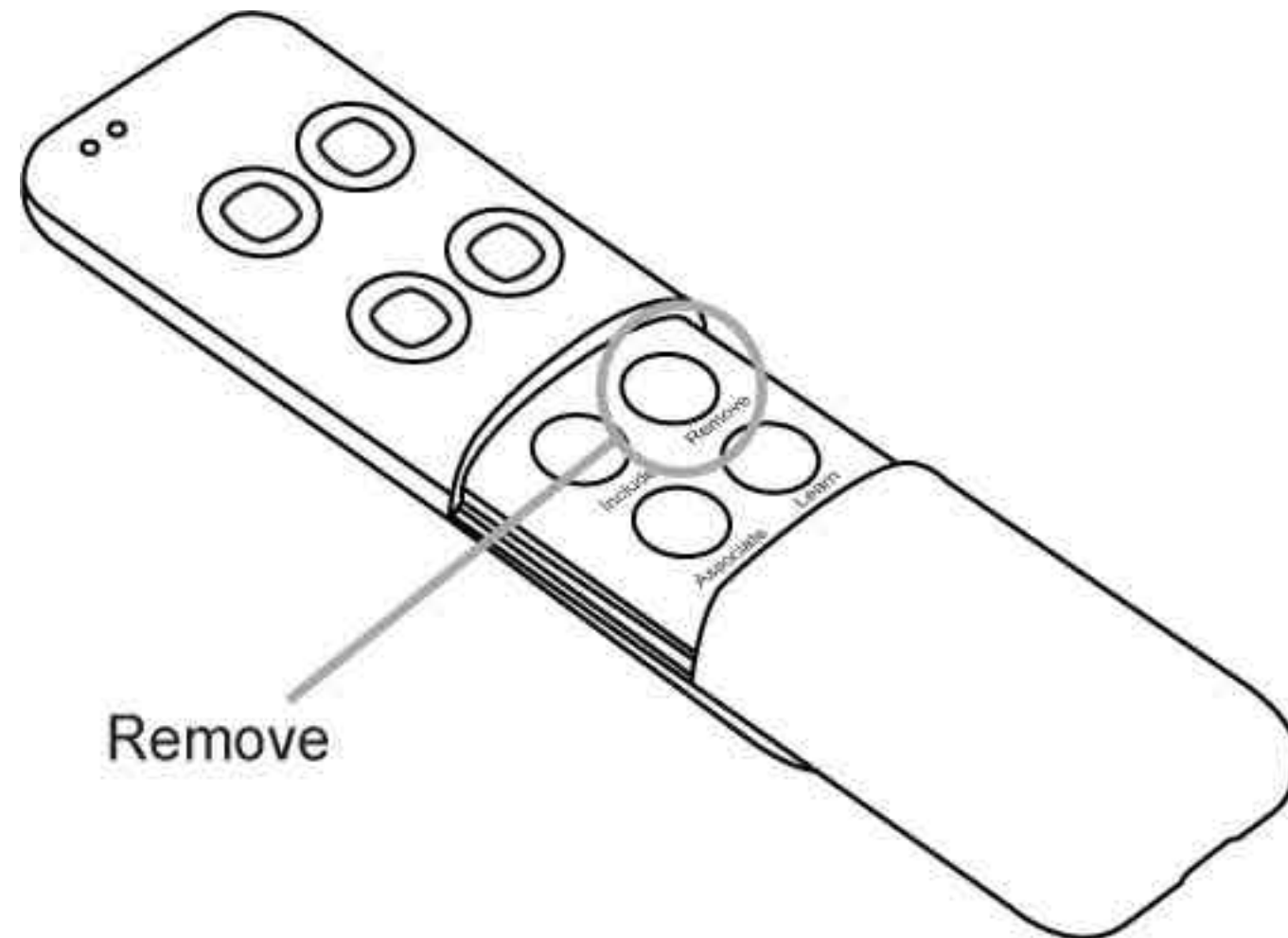

Note

To remove the Aeotec Micro Smart Energy Illuminator G2 from other controllers, please consult the operation manual for these controllers on how to remove Z-Wave products from an existing network.

2

While the Micro Smart Energy Illuminator G2 is powered in a 3-wire system, the external switch/button can be toggled 10 times in quick succession to initiate removing from the Z-Wave network. or the internal button can be pushed to initiate pairing into the Z-Wave network, if Micro Smart Energy Illuminator G2 was not put into in-wall box.

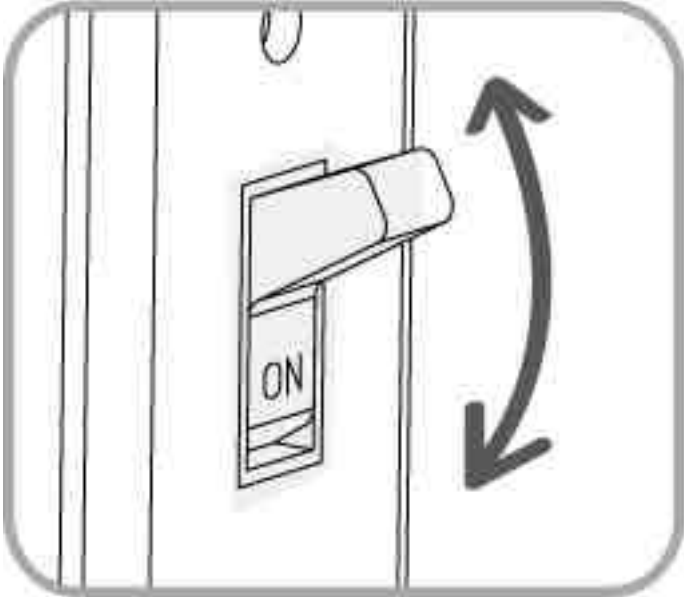

Troubleshooting

If the Aeotec Micro Smart Energy Illuminator G2 was removed from the Z-Wave network, the Status Indication LED will be blinking. If the Aeotec Micro Smart Energy Illuminator G2 was not successfully removed from the Z-Wave network, the Status Indication LED will either be solid on or off (depending on if the switch is on or off).

Note

Another way to reset Aeotec Micro Smart Energy Illuminator G2 is pressing and holding the button which is on Micro Smart Energy Illuminator G2 20 seconds, if Micro Smart Energy Illuminator G2 was not put into in-wall box.

Turning On/Off/Dim the Micro Smart Energy Illuminator G2

Use any of the below methods to allow power through or cut power from the Micro Smart Energy Illuminator G2.

- Through the usage of Z-Wave commands built into Z-Wave certified controllers and gateways. (The specific Z-Wave commands supporting this function are the Basic Command Class)
- Pressing the button on the Micro Smart Energy Illuminator G 2 will toggle power flow (on/off) through the Micro Smart Energy Illuminator G2. By holding the button, the lamp will be dimmed up or down.

Change Mode on the External Switch/Button Control

- The Aeotec Micro Smart Energy Illuminator G2 is set to be controlled via 2-state(flip/flop) external wall switch by default. Pushing and holding the button 6 seconds on the Micro Smart Energy Illuminator G2 will swap between this default mode and the momentary push button external wall switch mode.
- Through the usage of Z-Wave command built into Z-Wave certified controllers and gateways. (The specific Z-Wave command supporting this function is Configuration Command Class) Please consult the operation manual for these controllers for specific instructions on changing external wall switch mode of the Aeotec Micro Smart Energy Illuminator G2.

Monitoring Energy Consumption

The Aeotec Micro Smart Energy Illuminator G2 can report wattage energy usage or kWh energy usage to a Z-Wave gateway or controller when requested. If this function is supported by the gateway/controller, the energy consumption will be displayed in the user interface of the gateway/controller. (The specific Z-Wave commands supporting energy monitoring are the Meter Command Class. Automatic reports are sent to association group 1, which is setup via the Association Command Class.) Please consult the operation manual for these gateways/controllers for specific instructions on monitoring the Micro Smart Energy Illuminator G2.

Note

The Micro Illuminator G2 (without the words "Smart Energy") does not have the ability to monitor energy consumption.

Newsletter

Whenever we have something worthy of sharing we send out a newsletter. You can subscribe to it below and have Aeotec and home automation news delivered directly to your inbox.

Your Email Address:

New releases.

Aeotec has a number of new products in development for 2016, with the next of them to be announced in the near future. To find out what's new and when they're released, be sure to sign up to our newsletter. You can subscribe below and have Aeotec and home automation news delivered directly to your inbox.

Enter your email address:

About Aeotec.

We're creators of [home automation](#) products. We look at a home and imagine how it can be better through technology. Then we work to make it happen.

Find out more [about Aeotec](#) by Aeon Labs including information on [developing](#) with us.

Contact Aeotec.

With staff across the United Kingdom and the United States, and offices in China and Hong Kong, the team at Aeon Labs is only a few clicks away.

Visit our [contact page](#) to get in touch.



10 YEARS

[News](#) · [About](#) · [Contact Us](#) · [Legal & Privacy](#)

© 2006 - 2016 Aeon Labs LLC. All rights reserved.