

Scannen Sie den QR-Code, um die deutsche Version unseres Benutzerhandbuchs zu erhalten.

Scannez le code QR pour obtenir notre manuel d'utilisation en version française.

Escanee el código QR para obtener la versión en español de nuestro manual de usuario.

Scan de QR code voor de Nederlandse versie van onze gebruikershandleiding.

Scansionate il codice QR per ottenere la versione italiana del nostro manuale d'uso.

[https://www.switch-bot.com/
pages/switchbot-user-manual](https://www.switch-bot.com/pages/switchbot-user-manual)



User Manual

Contents

List of Components	01
Package Contents	03
Preparation	04
Installation	05
Using 3M Adhesive Tape	11
Detection Modes	14
LED Indicator Light	19
Battery Replacement	20
Resetting Factory Settings	21
Firmware Upgrades	21
Frequently Asked Questions	22
Specifications	24
Warranty	25
Contact & Support	27

List of Components

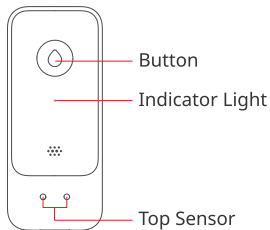
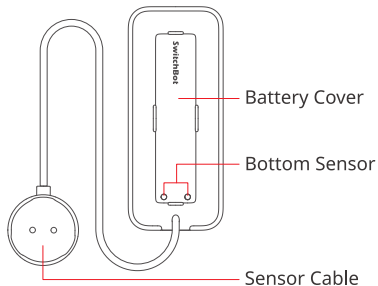

Indicator Light: shows device status.

Top Sensor: detects water droplets.

Button: used for pairing, testing and muting alarm sounds.

Bottom Sensor: detects water leaks.

Sensor Cable: detects water leak or water level.

Package Contents

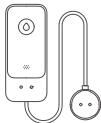

Water Leak Detector
with Sensor Cable × 1



3M Adhesive Tape
× 3



AAA Battery × 2



Triangle Opener × 1

Preparation

You will need:

- A smartphone or tablet using Bluetooth 4.2 or later.
- The latest version of our app, downloadable via the Apple App Store or Google Play Store.
- A SwitchBot account, you can register via our app or sign in to your account directly if you already have one.



iOS 14.0+



Android OS 5.0+

Installation

Step 1: Remove the Battery Cover

Use the Triangle Opener provided to open the Battery Cover.

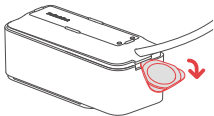

Step 2: Install batteries and test your device

① Insert the batteries into the battery slot, ensuring they are in the right direction.

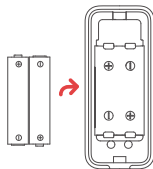

AAA battery × 2

② Align and close the battery cover.

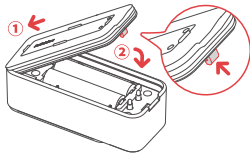

- ③ Press the button. If the Buzzer beeps and the Indicator Light flashes twice, your Water Leak Detector is now working normally.

Press the
button once.

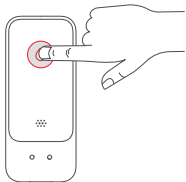

Step 3: Add to the SwitchBot app

Open our app, tap the "+" icon located in the right-hand corner of the home page, and select Add Device.

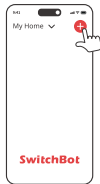

- Our app is regularly updated. Follow the in-app instructions to add your device.
- Registering an account or adding a device will not compromise your privacy, data is only for ensuring normal use of your device.

Step 4: Position the water detector

① Water leak detection

Lay the device where water leak monitoring is needed and ensure it would come into contact with leaking water.

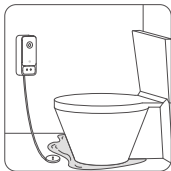

② Water level detection

Attach the 3M Adhesive Tape to the back of your device and install it to an appropriate position. Place the sensor and cable into water. Make sure the sensor is a bit below an acceptable water level.

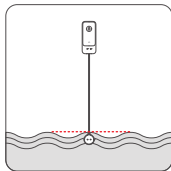

Using 3M Adhesive Tape

1. Rectangular Tape

Apply to the back of the detector and affix it to a surface.

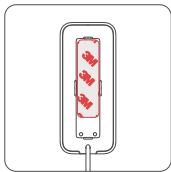

2. Round Tape

Suitable for water level detection:

Apply to the probe cable to prevent interference from water level changes caused by vibrations.

- ① Clean and dry the container surface.
- ② Keep the tape dry for at least 30 minutes for optimal adhesion.

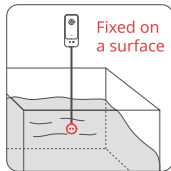

3. Semicircular Tape

Suitable for water leak and water level detection:

Apply to the probe cable to prevent movement.

Ensure the surface is clean and dry before use.

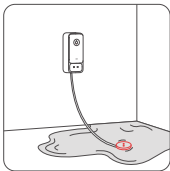
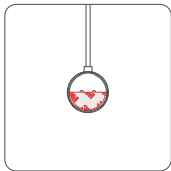

Detection Modes

1. Water leak detection

When any sensor on your device detects water, it will generate continuous sound alarms to alert you, and our app will send a water leak notification to your smartphone.

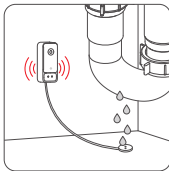

Drip alarms

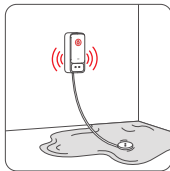

Leak alarms

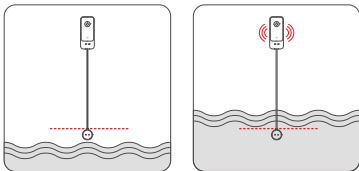

Water intrusion alarms

Please note: If water leaks are not handled after a sound alarm session, the device will emit sound alarms again. A sound alarm session lasts 5 minutes by default. You can change the duration setting on our app.

2. Water level detection

You can switch your device to water level detection at Mode > Dry alert on your detector's page via our app. When the Sensor Cable does not detect water, the detector will emit continuous sound alarms and the SwitchBot app will send you a dry alert notification.

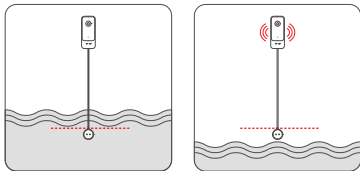

Please note: Water level changes caused by vibration may affect sensor detection.